

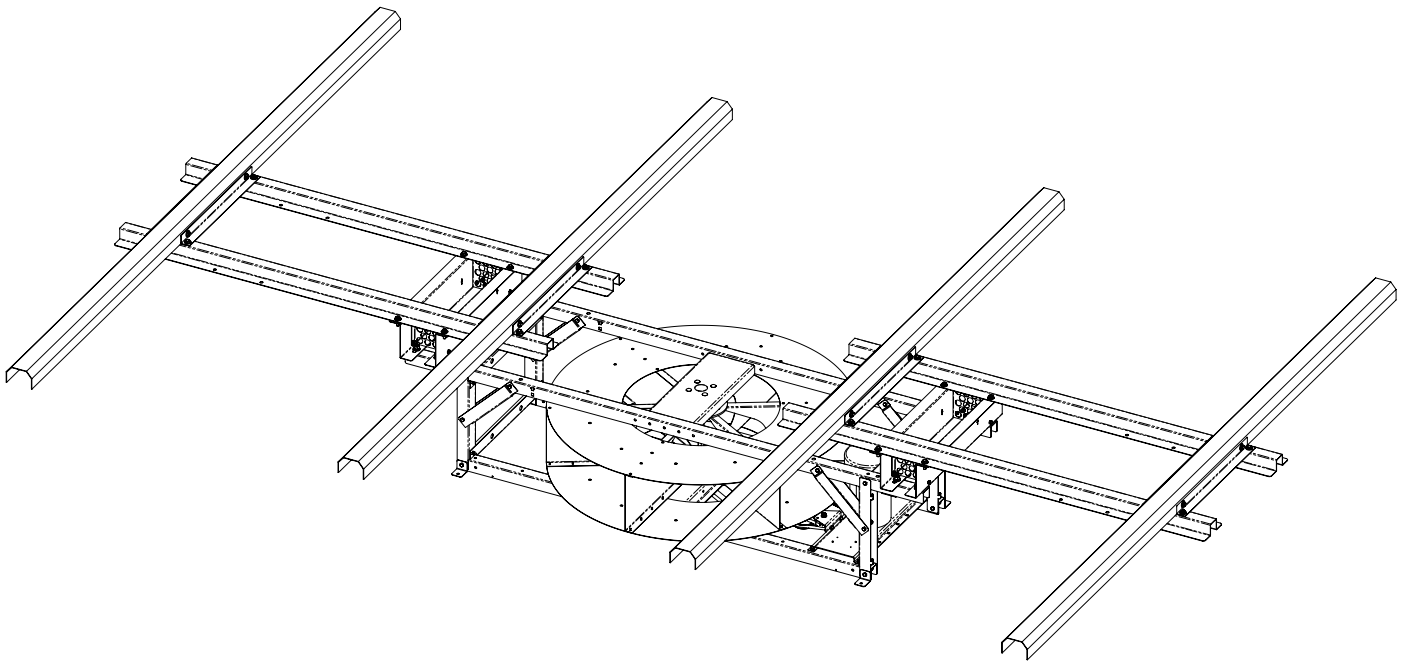

# 48" Hemisphere Fan Mounting Kit

## Installation Quick Sheet

640603



The Hemisphere Fan Mounting Kit is used to install a 48" Hemisphere Fan onto an existing Valli® Catwalk using a specially designed Catwalk Mount Kit. Not to be used with 72" Hemisphere Fan.

## Catwalk Mount Kit Installation

1. Pre-assemble the catwalk mount kit (640603) by assembling (2) pairs of brackets (640605) to every pair of hat rails (640604) using the 3/8" hardware provided and shown in Figure 1, including (8) 3/8-16 x 1" hex bolts (010666), (16) 3/8" flat washers (010430), (8) 3/8" lock washers (010253), and (8) 3/8-16 nylock nuts (010667) per sub-assembly. **Do not tighten hardware at this time.** Each fan will require (2) sub-assemblies, one mounted on each side of the fan frame.

Figure 1

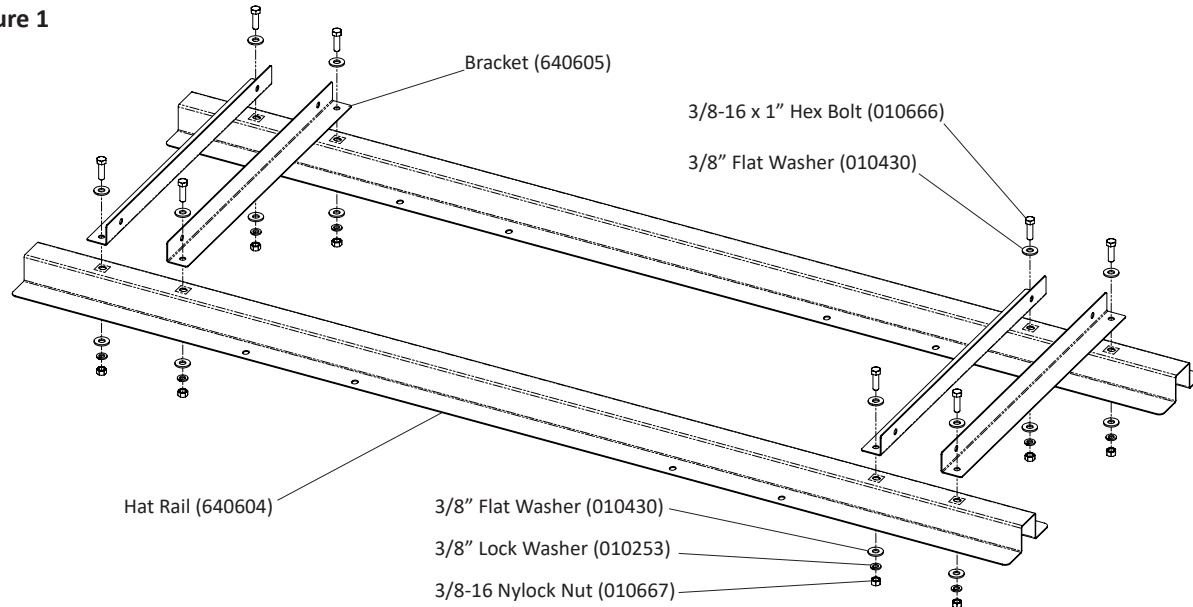

2. Once the catwalk mount sub-assemblies are loosely assembled, install them onto existing catwalk rails from below, as shown in Figure 2. The brackets (640605) should fit around the side of the catwalk rails. Push the hat rails (640604) up until flush with the catwalk rails. Once proper placement is achieved, use the pre-drilled holes in the brackets to drill  $\varnothing .391"$  [10mm] holes into the catwalk rails, as shown in Figure 3.

Figure 2

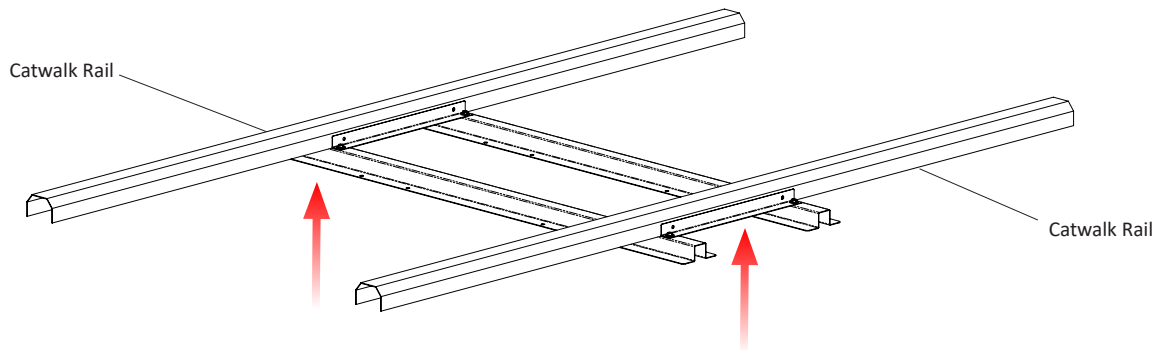
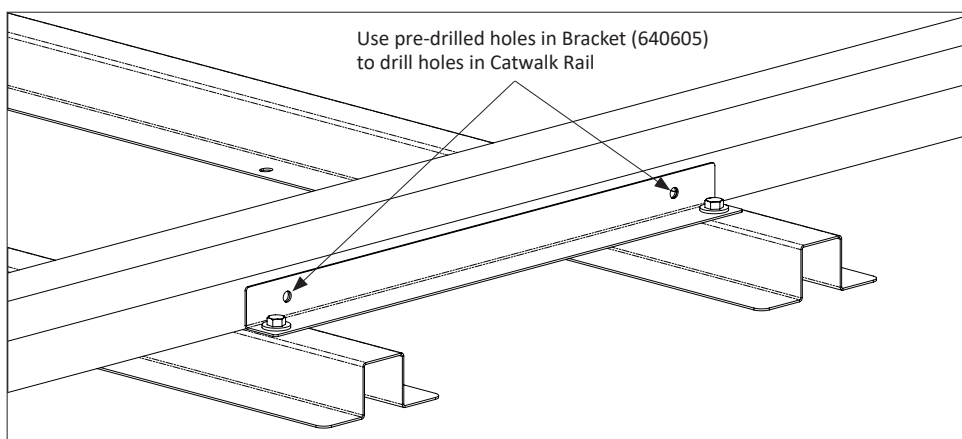

Figure 3



## Catwalk Mount Kit Installation - continued

3. After the catwalk mount sub-assemblies are in position and holes have been drilled into the catwalk rails, install the sub-assembled catwalk mount using the 3/8" hardware provided, as shown in Figures 4 and 5. Each sub-assembled catwalk mount will use (8) 3/8-16 x 1" hex bolts (010666), (16) 3/8" flat washers (010430), (8) 3/8" lock washers (010253), and (8) 3/8-16 nylock nuts (010667) per sub-assembly. **Tighten all hardware, including the hardware from the hat rail to the bracket.**

Figure 4

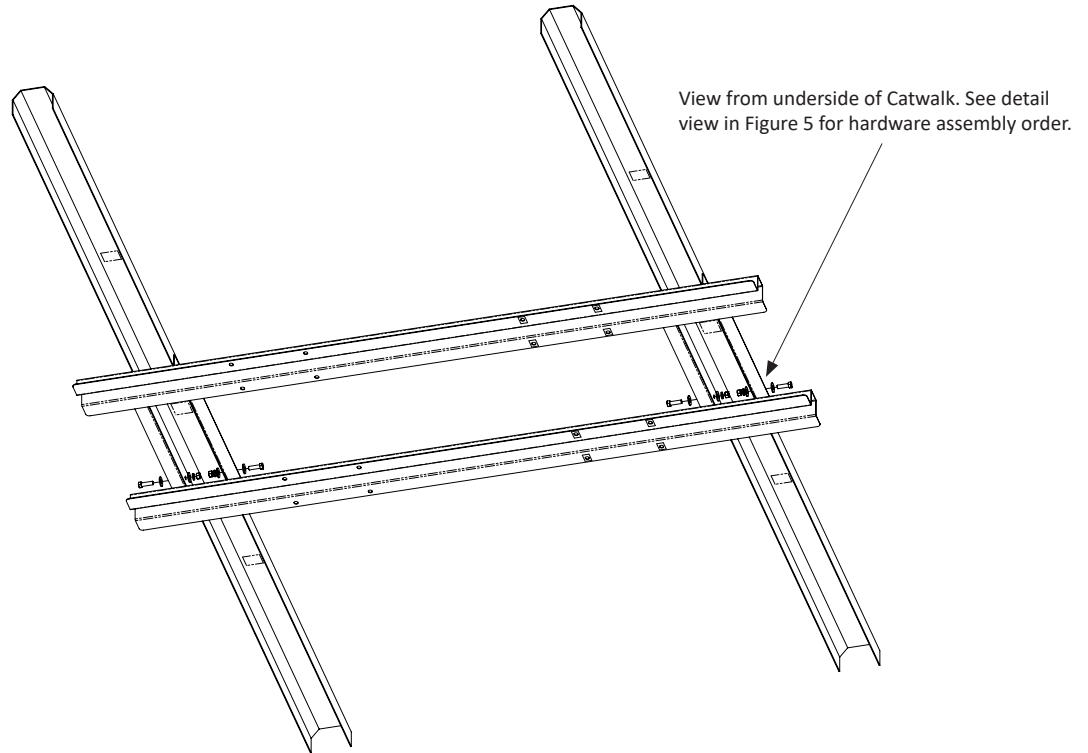
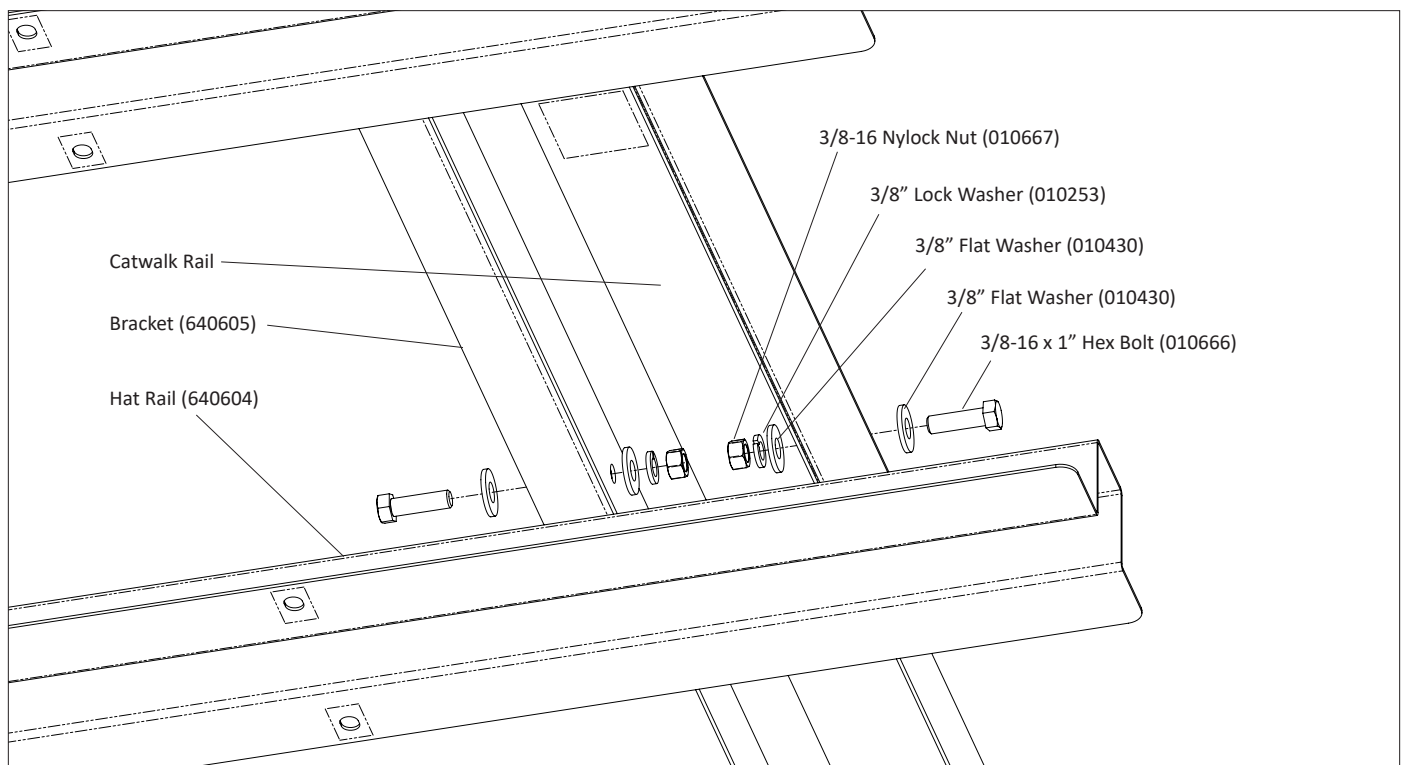

Figure 5



## Catwalk Mount Kit Installation - continued

- Once catwalk mount is installed onto the catwalk, pre-assemble the (2) ceiling spacers (972196) for the fans. Attach (2) spacer brackets (972124) to (2) spacer braces (972126) using (8) 5/16-18 x 3/4" hex bolts and (8) 5/16-18 nylock nuts, as shown in Figure 6. Tighten hardware.

**Figure 6**

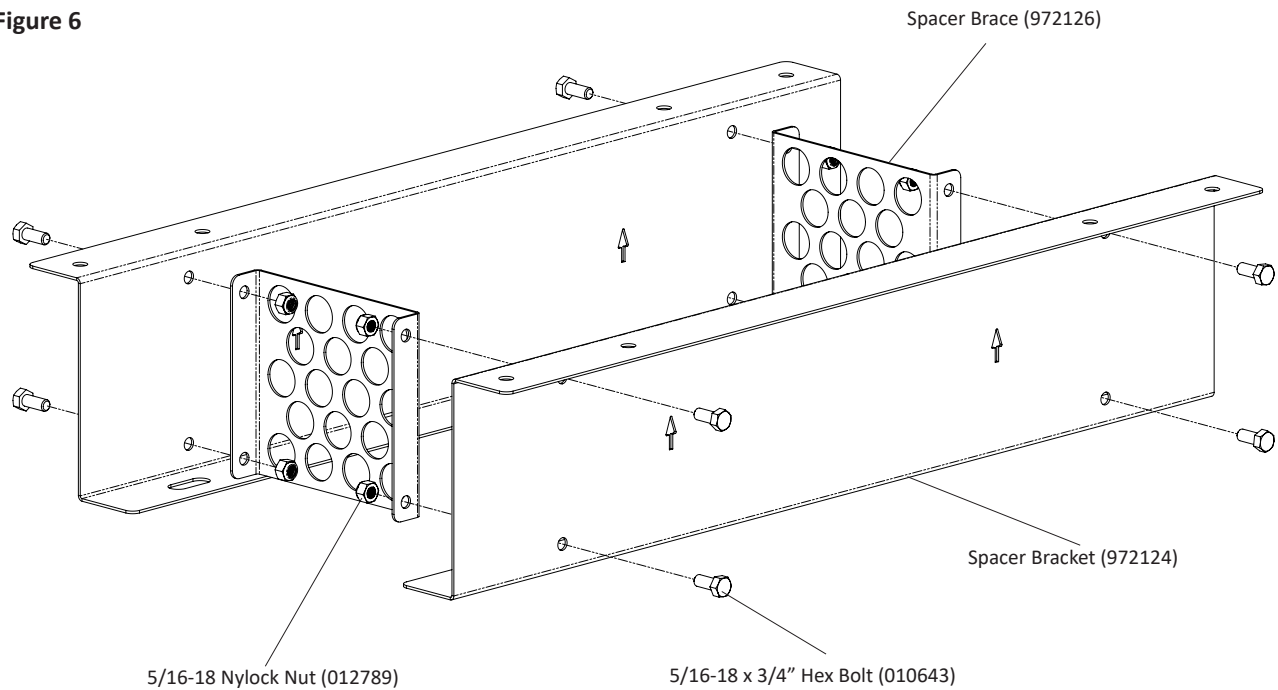

## Catwalk Mount Kit Installation - continued

5. Attach a pair of ceiling spacers to each Hemisphere Fan frame, one on each end, as shown in Figure 7. Assemble the ceiling spacers to the fan using (4) 1/2" x 1" hex bolts (012265), (4) 1/2" lock washers (010255), (4) 1/2" flat washers (010437), and (4) 1/2-13 hex nuts (011391), per ceiling spacer, as shown in detail in Figure 8. Tighten hardware.

**Figure 7**

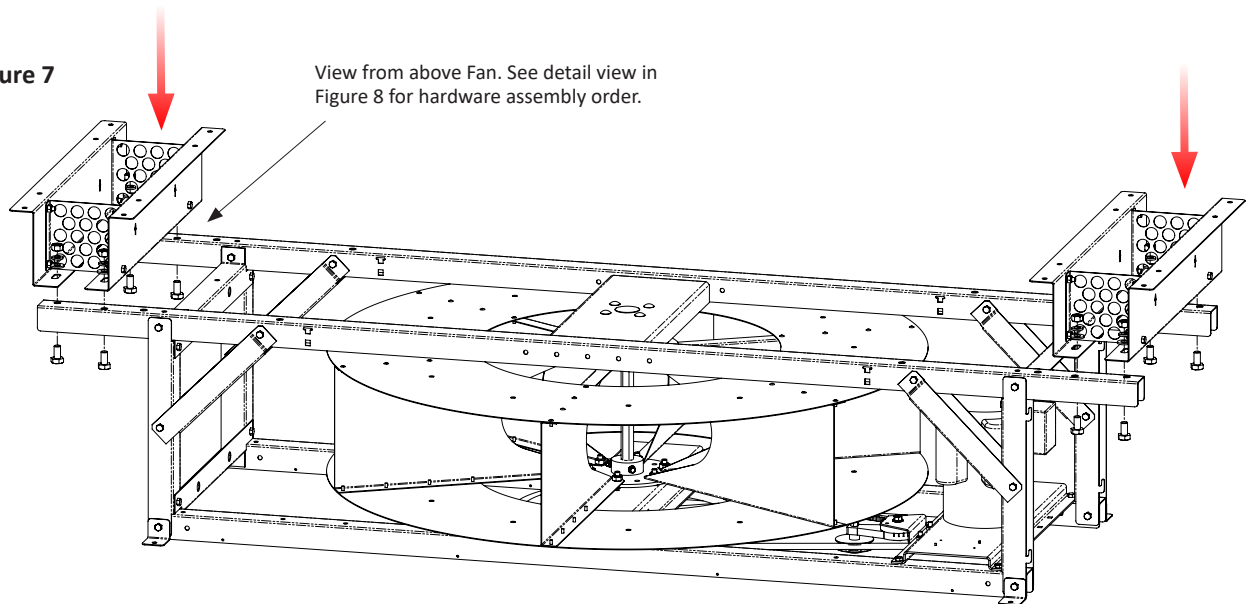

**Figure 8**

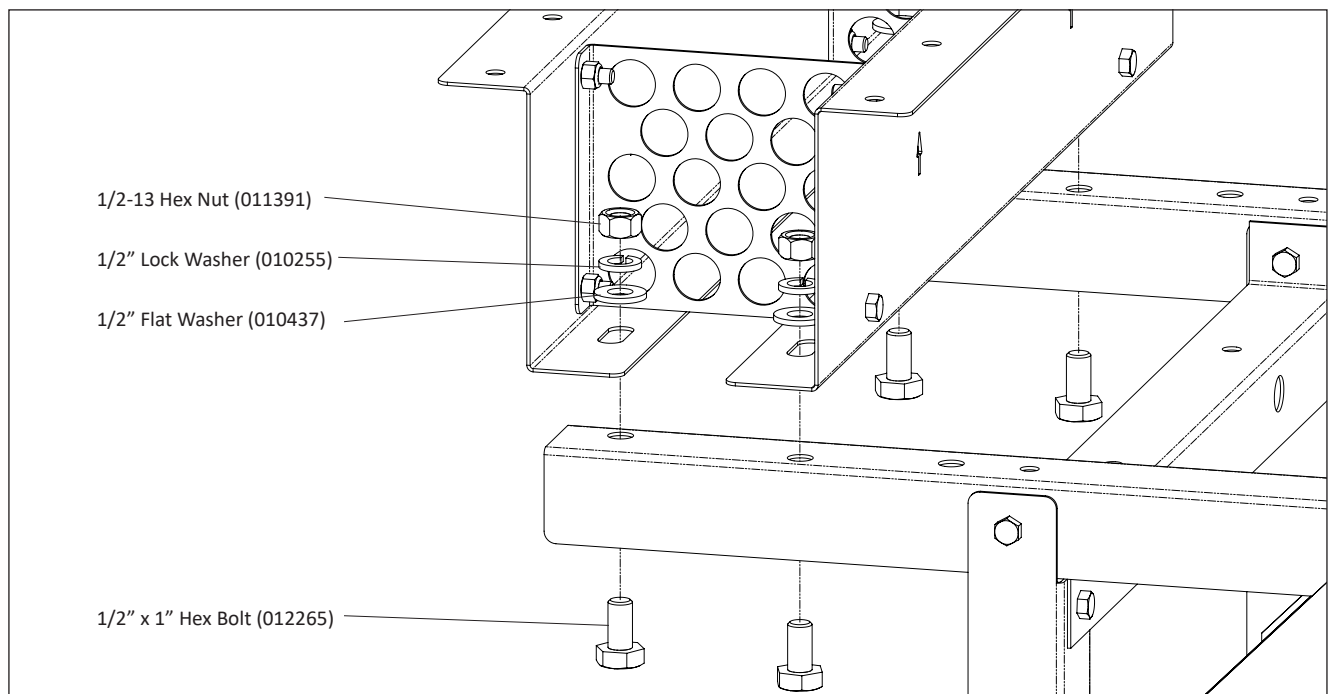

## Catwalk Mount Kit Installation - continued

6. Raise the Hemisphere Fan with the attached ceiling spacers up to the catwalk rails with the previously installed catwalk mounts, and assemble using the supplied 3/8" hardware, including (16) 3/8-16 x 1" hex bolts (010666), (32) 3/8" flat washers (010430), (16) 3/8" lock washers (010253), and (16) 3/8-16 nylock nuts (010667) per fan, as shown in Figures 9 and 10. Tighten all hardware to complete installation.

**Figure 9**

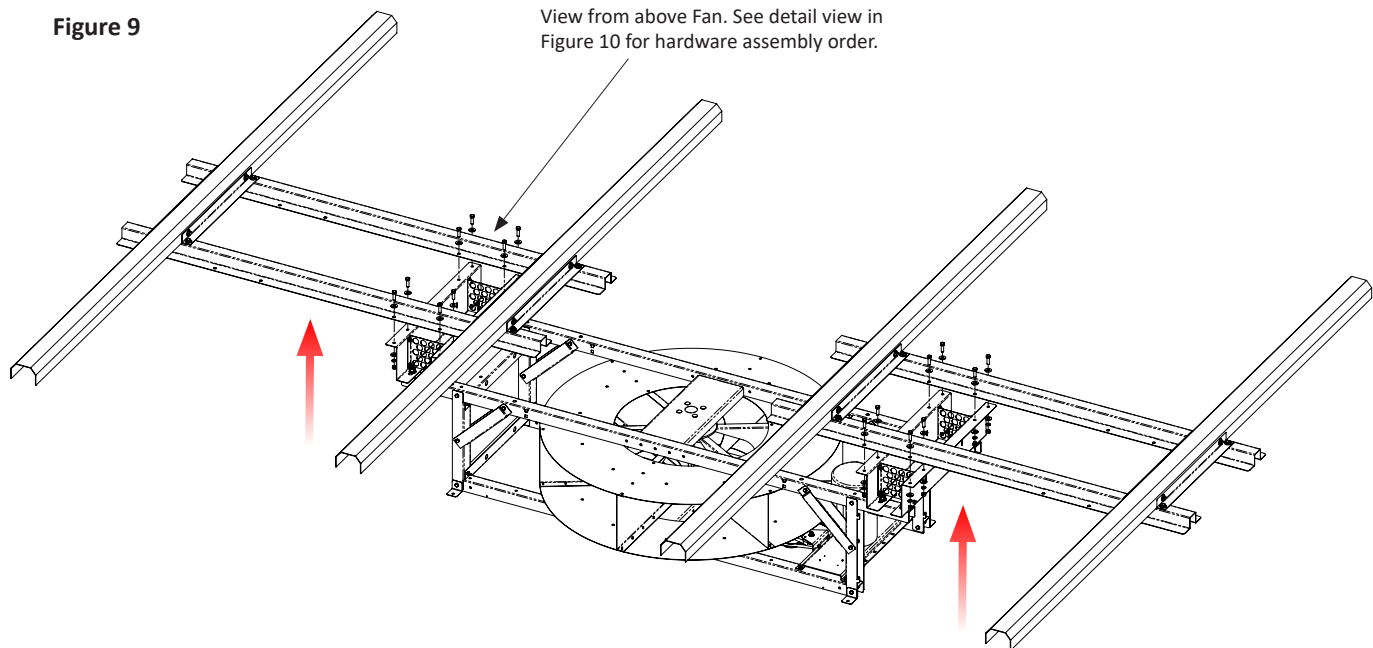

**Figure 10**

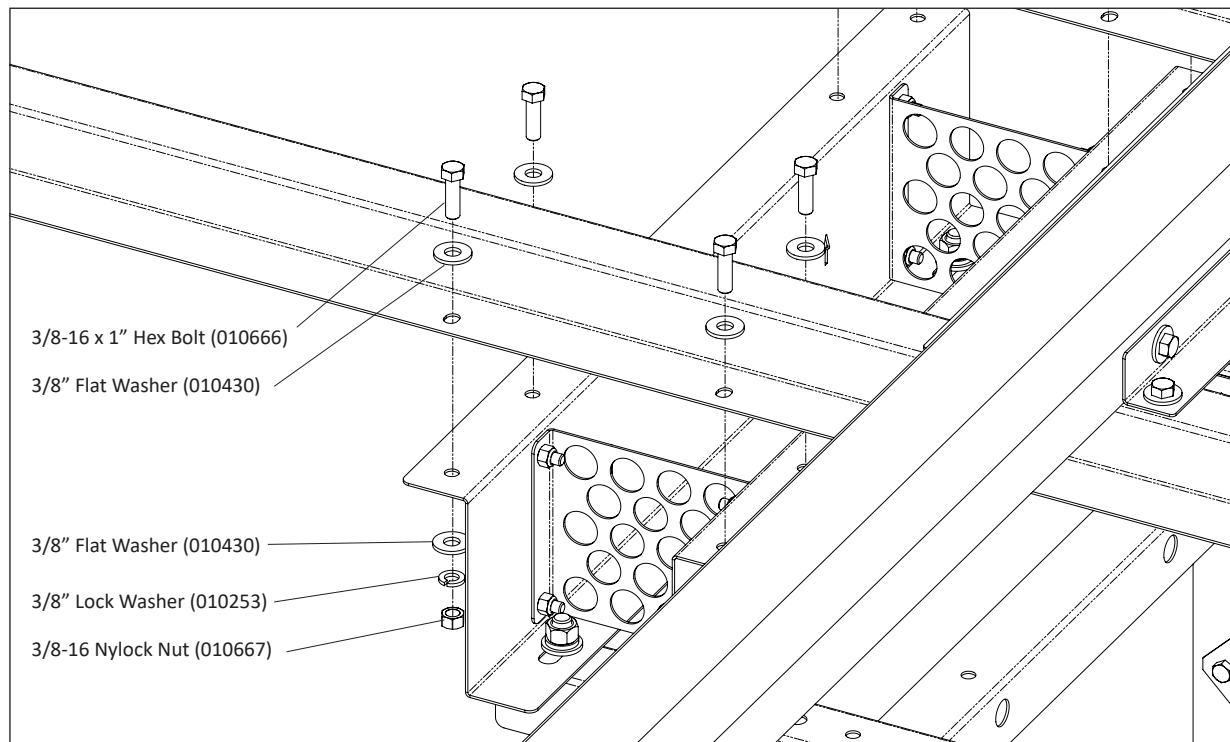

48" Hemisphere Catwalk Mount Kit - Exploded Drawing and Parts List

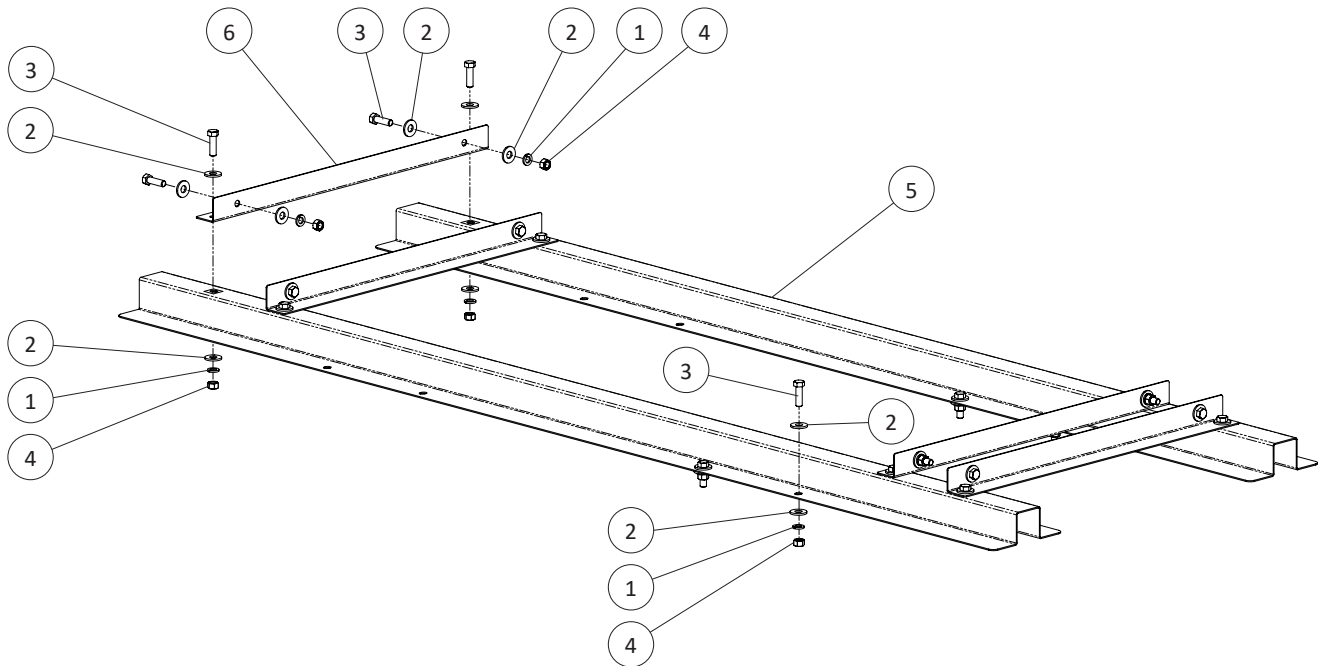

ITEM #	PART #	QTY	DESCRIPTION
48" HEMISPHERE CATWALK MOUNT KIT (640603)			
1	010253	48	3/8" LOCK WASHER
2	010430	96	3/8" FLAT WASHER
3	010666	48	3/8-16 X 1" HEX BOLT
4	010667	48	3/8-16 NYLOCK NUT
5	640604	4	HAT RAIL, HEMISPHERE MOUNTING KIT
6	640605	8	BRACKET, HEMISPHERE MOUNTING KIT
-	972196	1	6" CEILING SPACER KIT, DIRECTIONAL HEMISPHERE

(972196 Ceiling Spacer Kit shown on the next page.)

## 6" Ceiling Spacer Kit, Directional Hemisphere - Exploded Drawing and Parts List

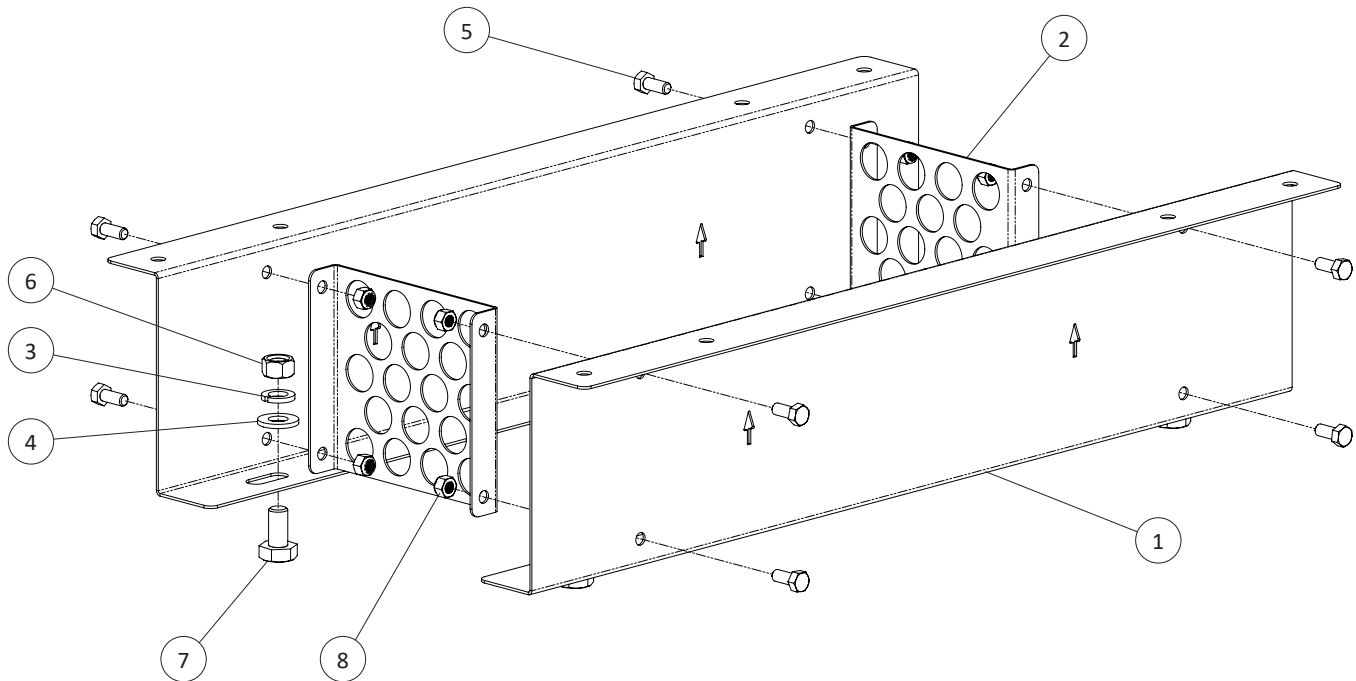

ITEM #	PART #	QTY	DESCRIPTION
<b>6" CEILING SPACER KIT, DIRECTIONAL HEMISPHERE (972196)</b>			
1	972124	4	BRACKET, 6" CEILING SPACER
2	972126	4	BRACE, 6" CEILING SPACER
-	972138	1	HARDWARE BAG, 6" CEILING SPACER
<b>HARDWARE BAG, 6" CEILING SPACER (972138)</b>			
3	010255	8	1/2" LOCK WASHER
4	010437	8	1/2" FLAT WASHER
5	010643	16	5/16-18 X 3/4" HEX BOLT
6	011391	8	1/2-13 HEX NUT
7	012265	8	1/2" X 1" HEX BOLT
8	012789	16	5/16-18 NYLOCK NUT

### North America:

Phone: 800.99VALCO; 800.998.2526

Fax: 419.678.2200

Email: [sales@val-co.com](mailto:sales@val-co.com)

990339

[-]

8

### International:

Phone: (+1) 419.678.8731

Fax: (+1) 419.678.2200

Email: [intl.sales@val-co.com](mailto:intl.sales@val-co.com)