

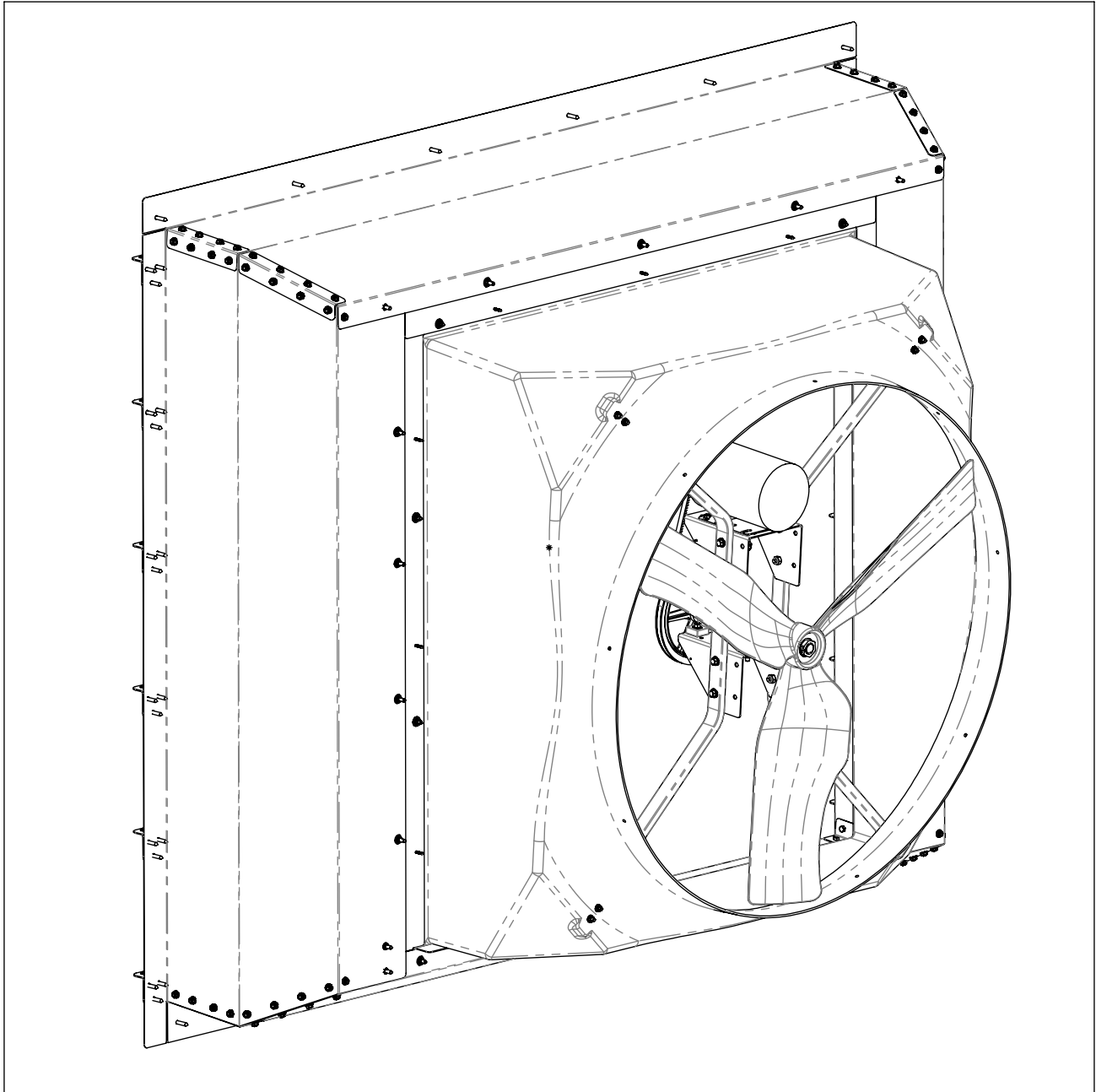

# Internal 50" Fan Adapter Kit

For Use With 819045 / 819255 Transition  
Installation Quick Sheet



***NOTICE! This adapter kit is designed to be used with a Val-co Interior Mount 50" fan. If used with a fan from other manufacturers, warranty does not apply. Some steps for mounting may vary if using another fan.***

***NOTICE! Total weight with transition doors and Val-co fan is 653 lbs. Consult with a structural engineer to confirm the building and wall will support this offset weight before install.***

# Adapter Kit Installation to 54" Transition

## Adapter Assembly

1. Following the install of the transition into the rough opening, install the adapter kit components onto the inside of the transition using the hardware provided. Some hardware from the 54" transition may need to be removed if all of it was completely installed. Remove the hardware where circled in red in **Figure 1**.
2. Using the 5/16-18 x 1" bolts (010645), 5/16-18 nuts (501441) and 5/16" flat washers (010458), secure the adapter plates into the transition in the order of the top plate first then the left and right plates. The bottom plate will be last. Be careful not to install the bolts circled in red that connect the plates together until they are all in place.

**Note:** The washers are to be used where the squares are located on the outside of the transition and where new holes are drilled. Washers are not needed where arrows indicate in the 4 corners.

3. After all (4) adapter plates are started, use a 3/8" drill bit to drill out the transition panels in the remaining holes circled in blue to match the adapter plate.

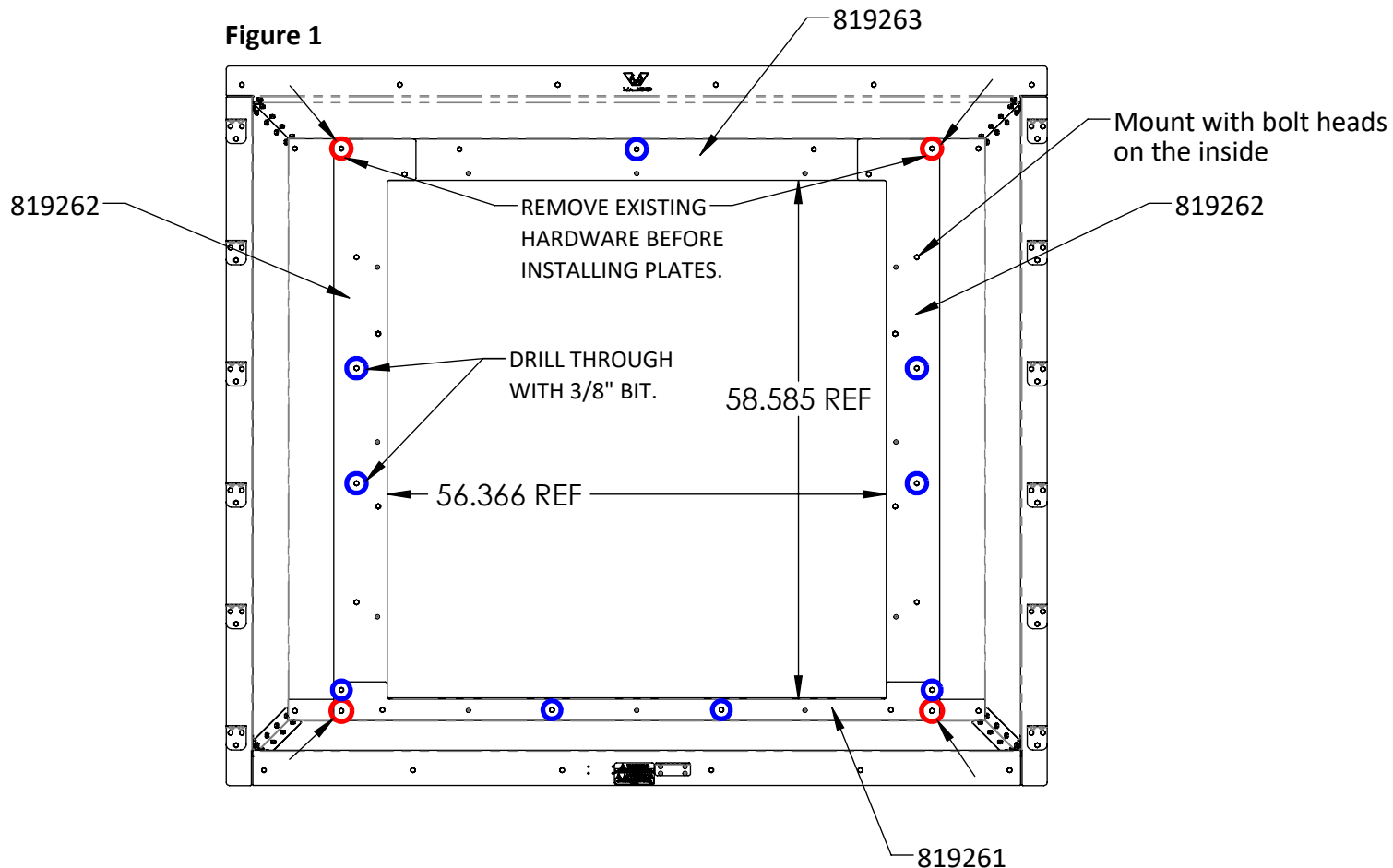

### North America:

Phone: 800.99VALCO (800.998.2526)  
Fax: 419.678.2200  
Email: sales@val-co.com

990349 [-] 4/8/2025  
Page 2

### International:

Phone: (+1) 419.678.8731  
Fax: (+1) 419.678.2200  
Email: intl.sales@val-co.com

## Mounting Fan to Adapter Kit

1. With the adapter kit in place, insert the fan from the door side of the transition and support on the ledge of the transition. Use (12) 10-16X1.5" Self Drill Screws (819074) and (12) shutter clips (936013) to fasten the fan from the inside of the transition, aligning the holes of the fan housing and adapter plate at the blue circles.
2. Use the adapter plate, from the exterior of the transition, to align hand drill for drilling 11/32" holes in the fan housing at the red circles. Use (10) 5/16-18 x 1" bolts (010645) from the inside of the fan. Using the (10) 5/16-18 nuts ( 501441), secure the fan to the transition, ensure the bolts are tight for all.
3. With all of the bolts tight, use caulk along the top and sides of the fan to help eliminate rain and air leaks.
4. Before starting up the fan, ensure that the blade does not contact the orifice. If the blade contacts, adjust accordingly.

**NOTE:** DIMENSIONS SHOWN FOR REFERENCE ON CLEARANCE.

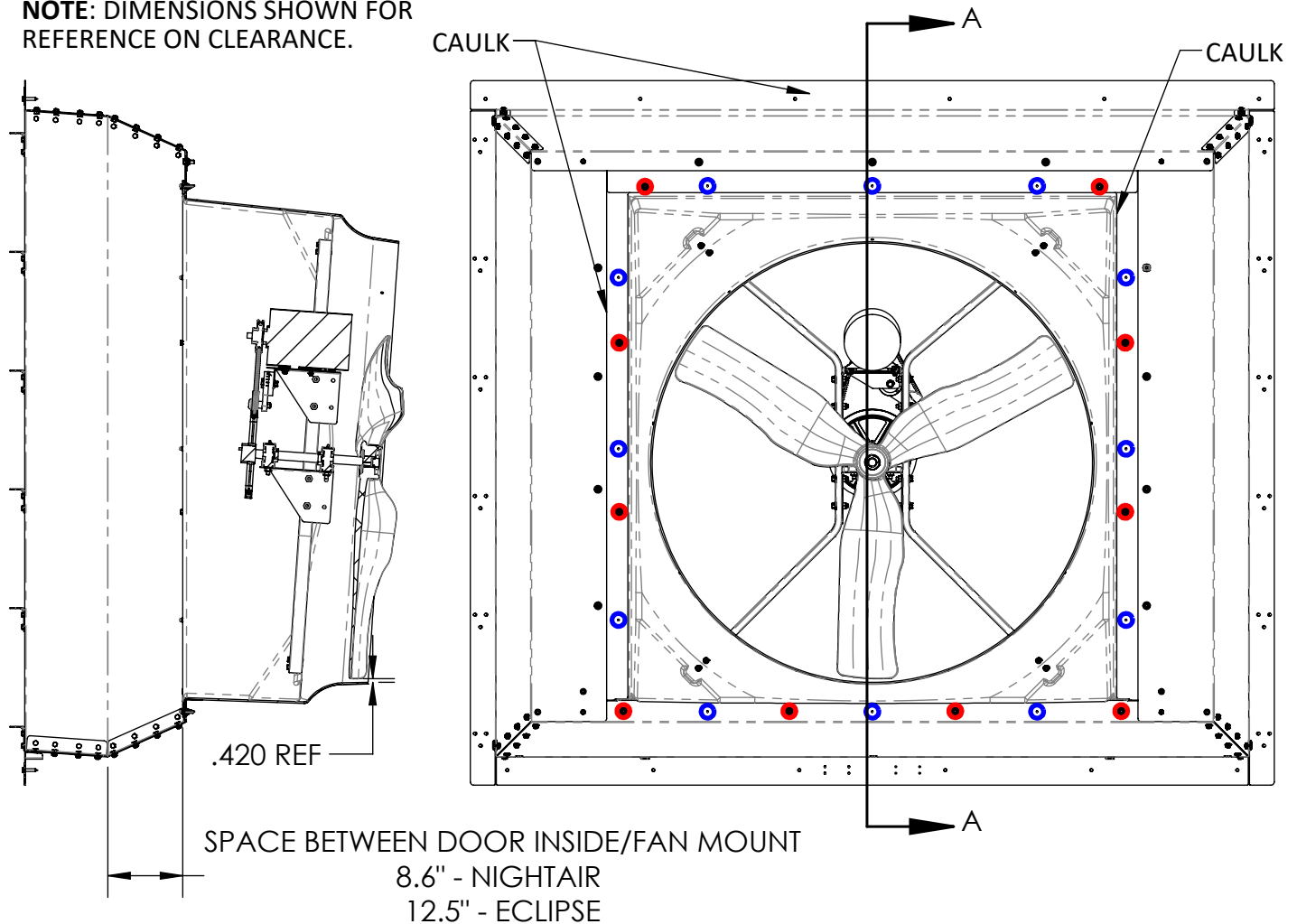

SECTION A-A  
SCALE 1 : 20

### North America:

Phone: 800.99VALCO (800.998.2526)  
Fax: 419.678.2200  
Email: sales@val-co.com

990349 [-] 4/8/2025  
Page 3

### International:

Phone: (+1) 419.678.8731  
Fax: (+1) 419.678.2200  
Email: intl.sales@val-co.com

## Parts List

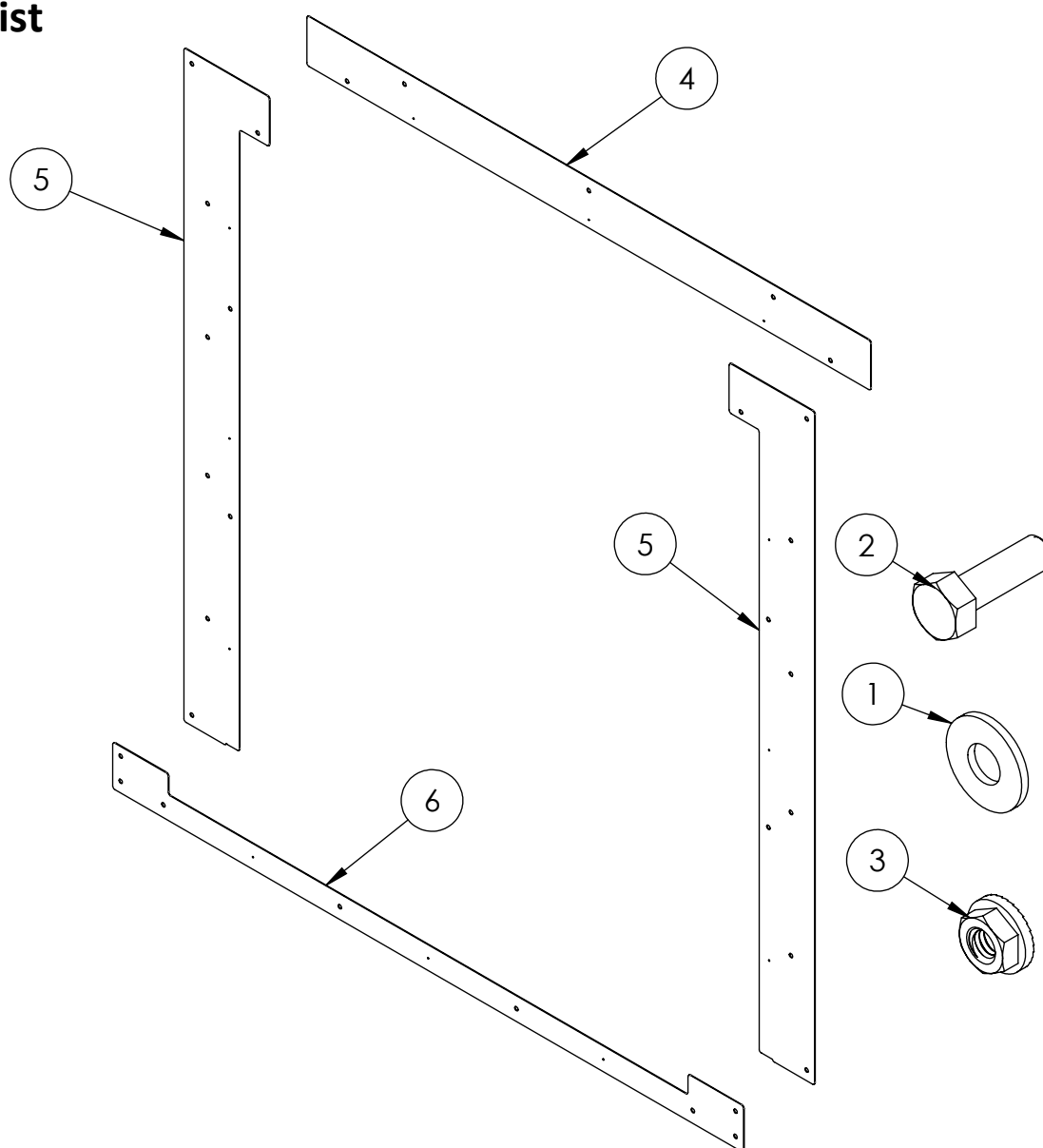

Item No.	Part No.	Description	Qty
<b>50" Interior Mount Fan Adapter kit for Transition - 819260</b>			
1	010458	WASHER, FLAT, 5/16"	24
2	010645	BOLT, HEX, 5/16-18 X 1"	30
3	501441	NUT, HEX, FLG, SERRATED, 5/16-18	30
4	819261	50" INT FAN ADAPTER, TOP	1
5	819262	50" INT FAN ADAPTER, RIGHT/LEFT	2
6	819263	50" INT FAN ADAPTER, BOTTOM	1

### North America:

Phone: 800.99VALCO (800.998.2526)

Fax: 419.678.2200

Email: sales@val-co.com

990349 [-] 4/8/2025

Page 4

### International:

Phone: (+1) 419.678.8731

Fax: (+1) 419.678.2200

Email: intl.sales@val-co.com