



Quick Sheet Instructions

DRIVE GUARD, PULLET TROUGH

Installation Instructions:

The flat chain drive pullet guard is designed to be installed on existing flat chain systems and secured with three (3) self-drilling screws.

1. Open the front cover of the flat chain drive sprocket.
2. Place the pullet guard over the trough.
3. Slide the pullet guard to the left so that it contacts the edge of the chain stripper.
4. Secure the guard with two (2) screws on the front and one (1) screw on the left rear flange of the cover.

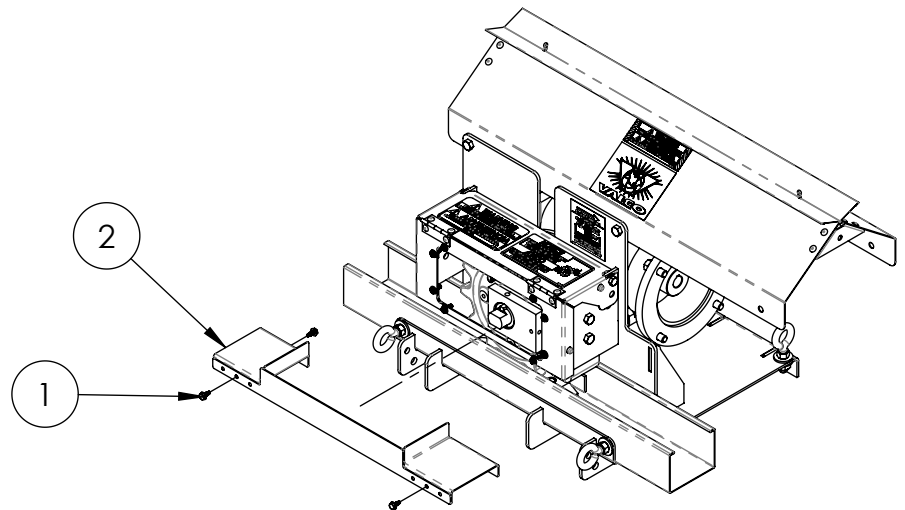
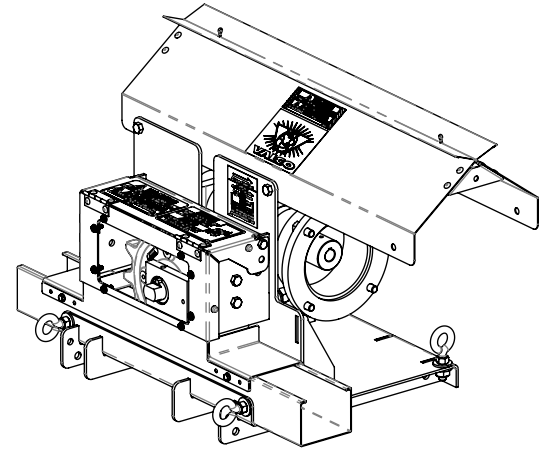

BILL OF MATERIALS

ITEM #	PART #	QTY	DESCRIPTION
1	012410	3	#10 X 1/2" SELF-DRILLING SCREW
2	421804	1	DRIVE GUARD, PULLET TROUGH

North America:

Phone: 800.99VALCO (800.998.2526)

Fax: 419.678.2200

Email: sales@val-co.com

990307 [-] 6/18/2024

Page 1

International:

Phone: (+1) 419.678.8731

Fax: (+1) 419.678.2200

Email: intl.sales@val-co.com