



Divided Extension Hopper

421010

Quick Sheet

Introduction

For use in 410200 2 Line, 1 Way, Floor Flat Chain Hopper. Can be used with 411027 Lid. The divided hopper splits the base hopper into 2 compartments that each can hold up to 400 lb (at 40 lb/cu ft feed density). In this manner, two different ratios can be fed with a single drive.

Assembly Instructions

Step 1: Assemble Divided Hopper Extension and Taper Panel Assembly separately, using provided 5/16-18 X 3/4" Truss Bin Bolts and 5/16-18 Hex Flange Nuts, as shown below in exploded drawing.

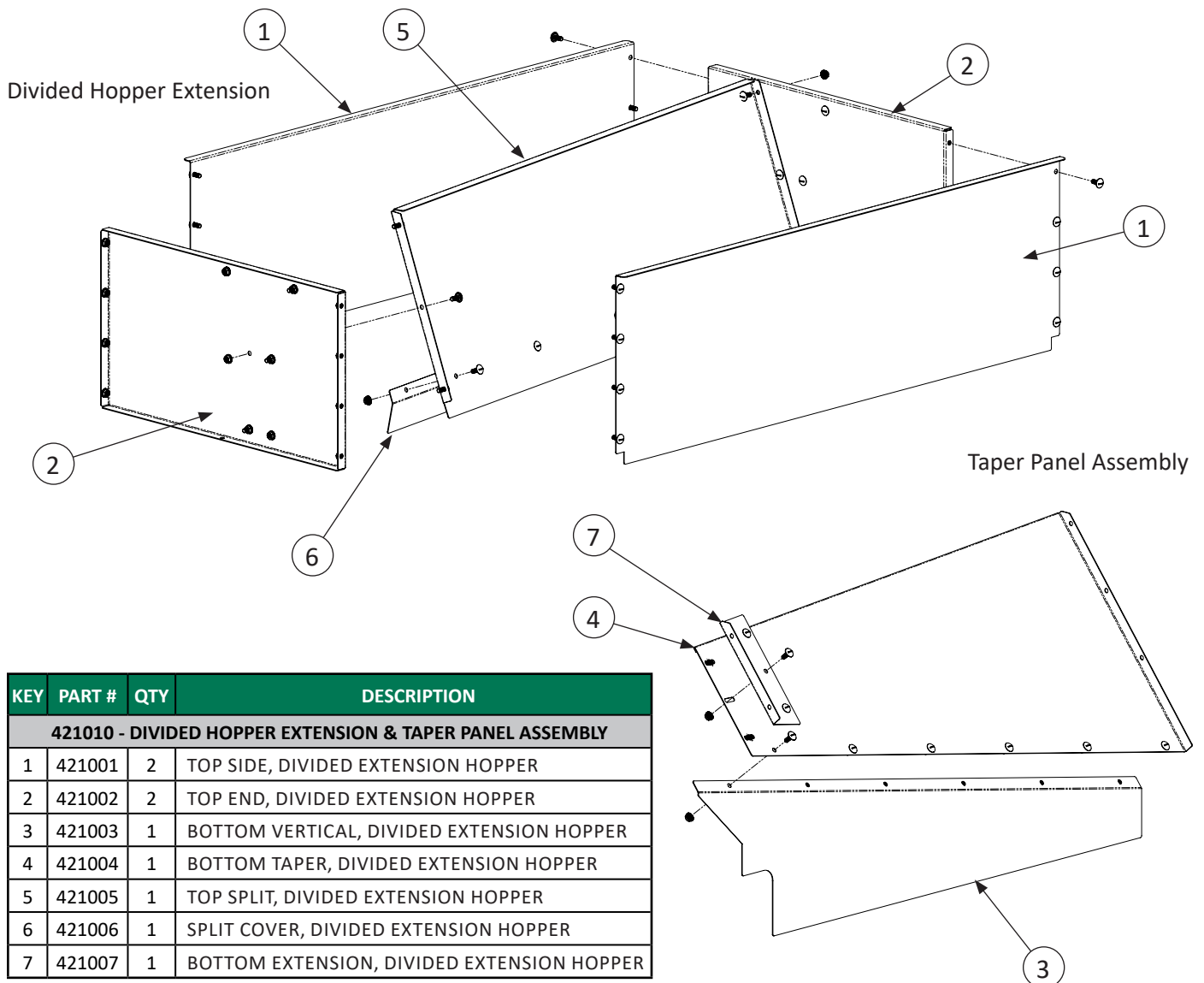

Step 2: Use provided Template to locate Taper Panel Assembly inside Hopper and then use pre-drilled holes in flanges of Taper Panel Assembly to mark holes to be drilled in Hopper. Use 3/8" drill bit. Assemble Taper Panel Assembly to Hopper using 5/16-18 Truss Bin Bolts and 5/16-18 Hex Flange Nuts, as shown below.

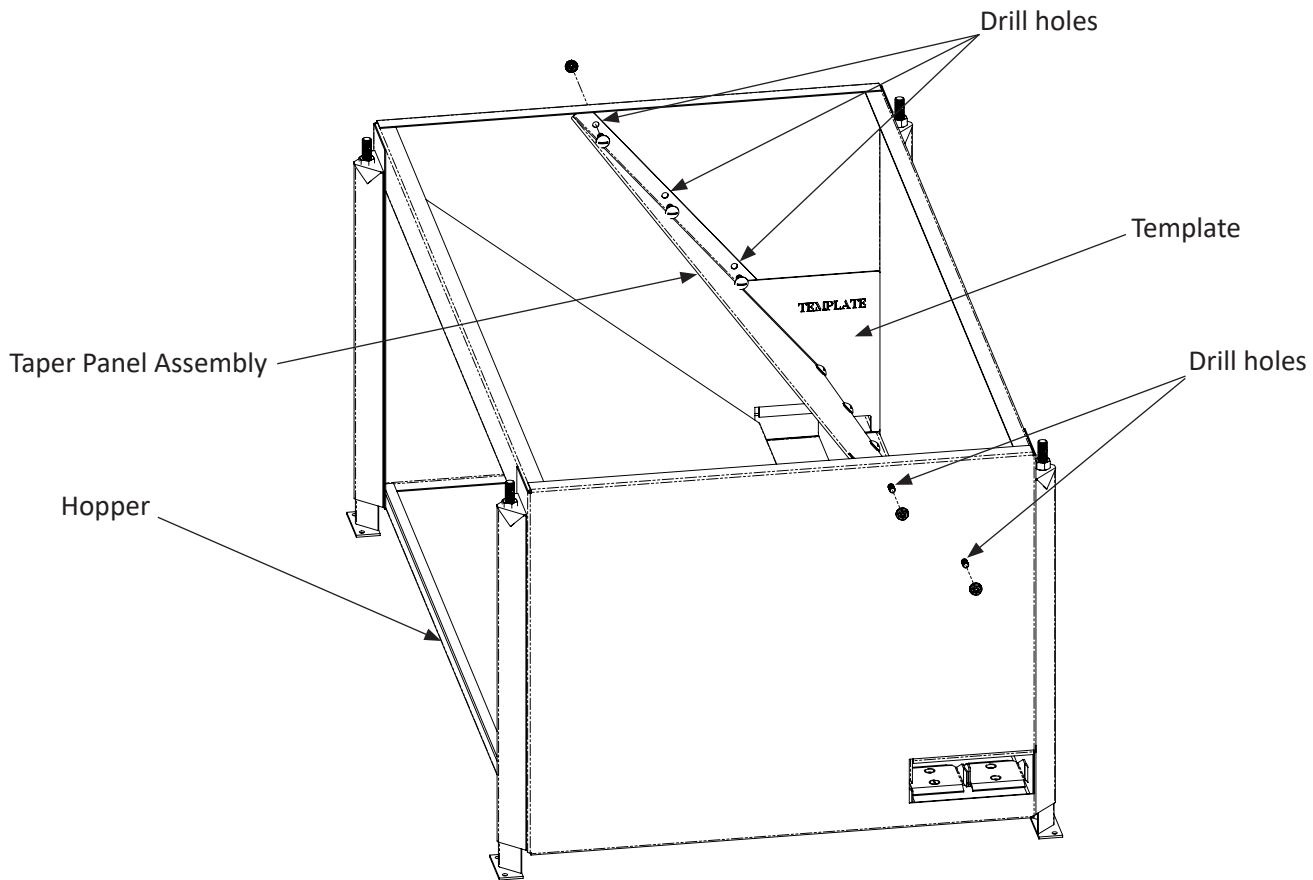

Step 3: Assemble Divided Hopper to Taper Panel Assembly using 5/16-18 Truss Bin Bolts and 5/16-18 Retainer Nuts. Use holes in Taper panel Assembly as a template to drill 9/16" holes in Hopper flanges to attach retainer nuts. Once secured, cover with Lid.

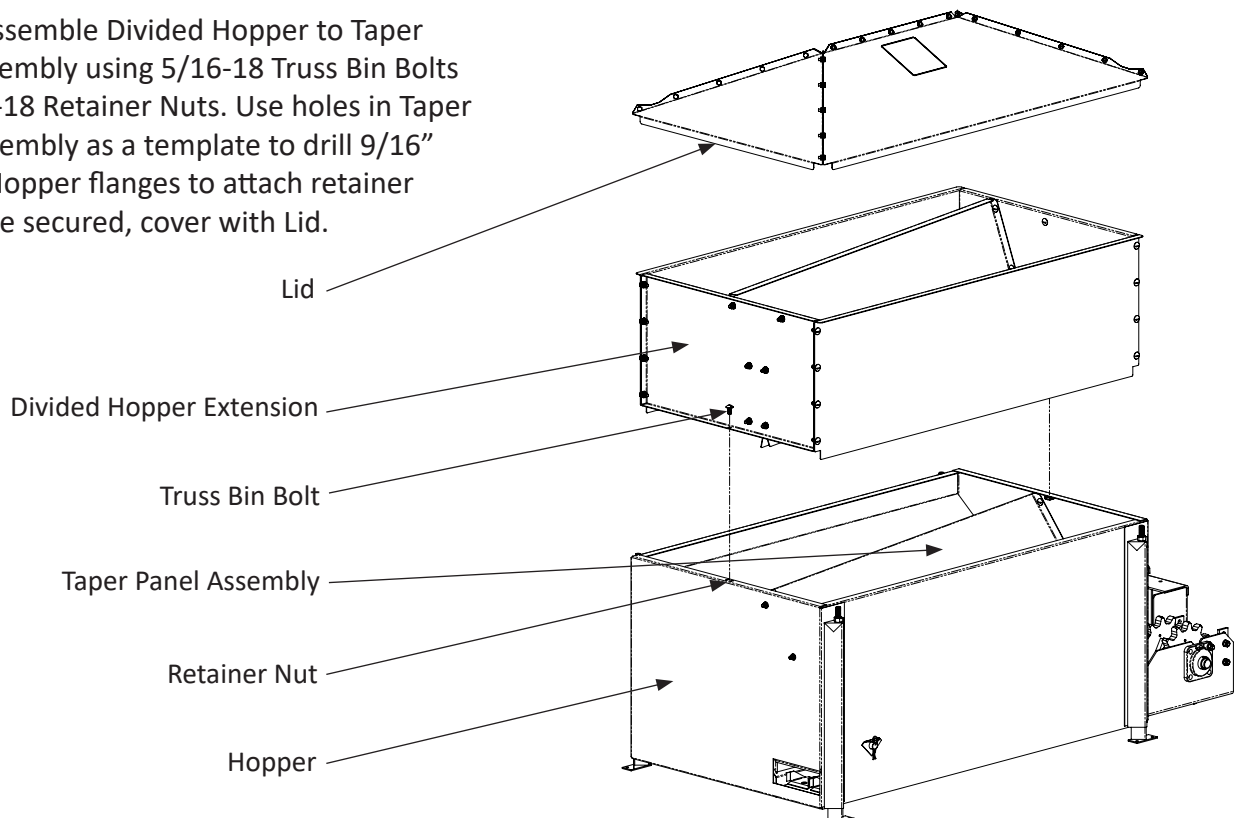

Divided Hopper Extension Repair Parts

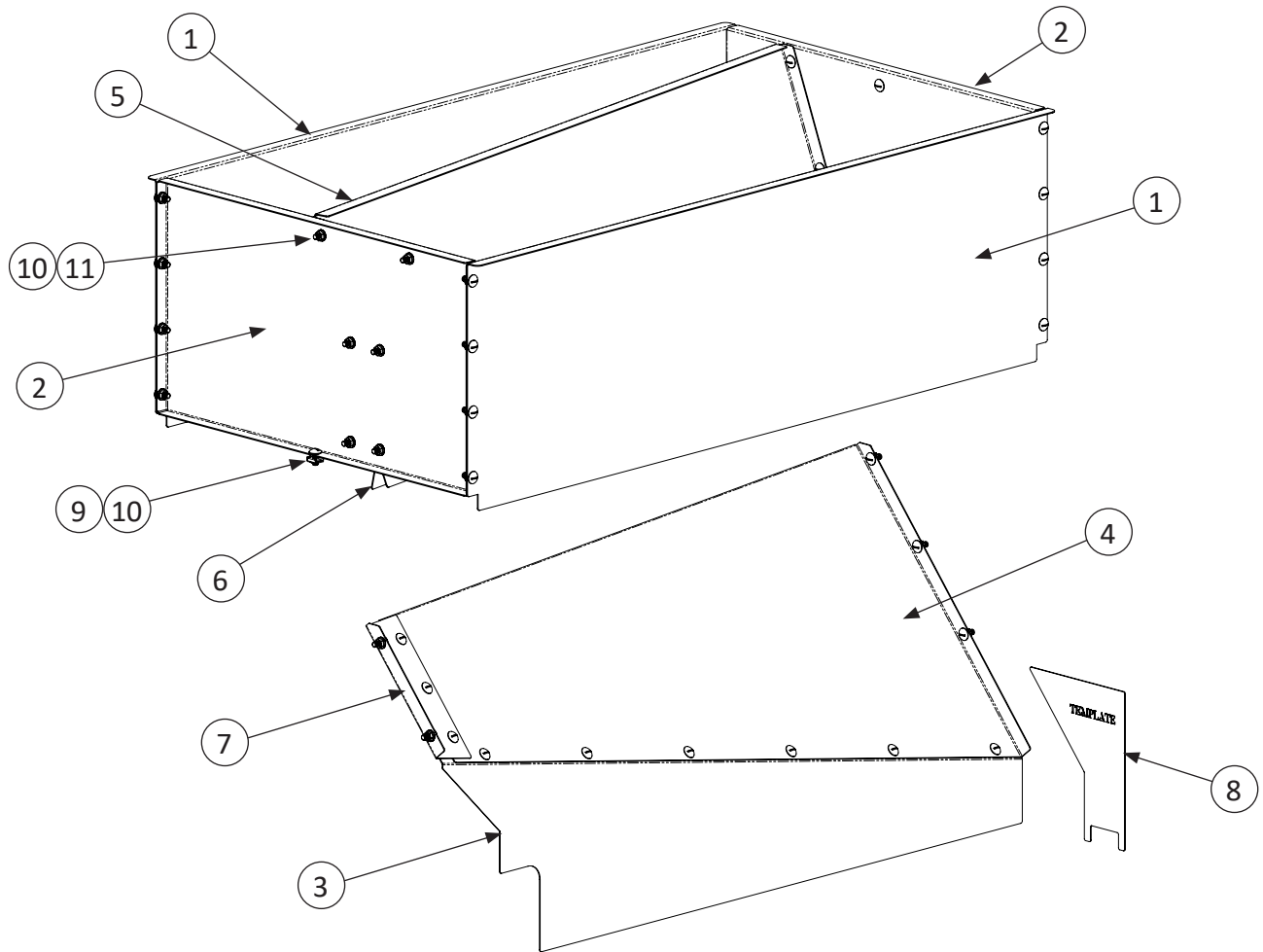

KEY	PART #	QTY	DESCRIPTION
421010 - DIVIDED EXTENSION HOPPER			
1	421001	2	TOP SIDE, DIVIDED EXTENSION HOPPER
2	421002	2	TOP END, DIVIDED EXTENSION HOPPER
3	421003	1	BOTTOM VERTICAL, DIVIDED EXTENSION HOPPER
4	421004	1	BOTTOM TAPER, DIVIDED EXTENSION HOPPER
5	421005	1	TOP SPLIT, DIVIDED EXTENSION HOPPER
6	421006	1	SPLIT COVER, DIVIDED EXTENSION HOPPER
7	421007	1	BOTTOM EXTENSION, DIVIDED EXTENSION HOPPER
8	421008	1	TEMPLATE, DIVIDED EXTENSION HOPPER
421009 - HARDWARE BAG			
9	011406	2	5/16-18 RETAINER NUT
10	501440	52	5/16-18 X 3/4" TRUSS BIN BOLT
11	501441	50	5/16-18 HEX FLANGE NUT

North America:

Phone: 800.99VALCO; 800.998.2526

Fax: 419.678.2200

Email: sales@val-co.com

990295

REV [-]

International:

Phone: (+1) 419.678.8731

Fax: (+1) 419.678.2200

Email: intl.sales@val-co.com