



# Quick Sheet Instructions

## LED Feeder Light Assembly

820022



*This LED light assembly may be used on Val-co® Fuze Control Pans or other brand name control pans.*

### Positioning and adjusting assembly

Loosen the hose clamps to adjust the assembly as required for best possible positioning. Secure clamps after positioning. ***Assembly may be positioned on either side of or on the bottom of the feed tube.***

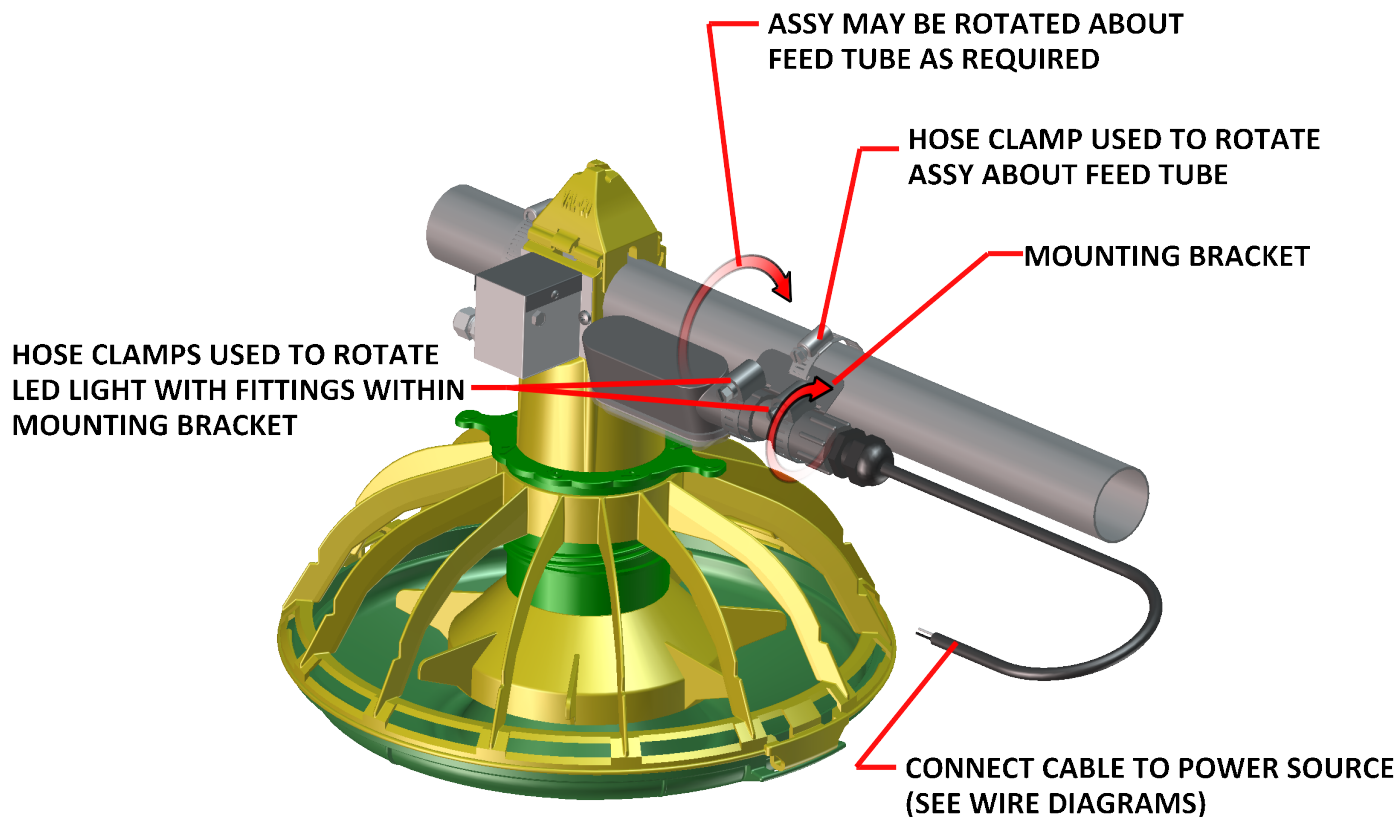

990048  
REV [C]

Wiring Diagrams - Single Phase

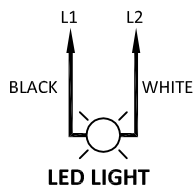

BASIC WIRE DIAGRAM FOR LED LIGHT  
WIRING MUST BE DONE BY LICENSED ELECTRICIAN.  
ALL LOCAL AREA CODES MUST BE FOLLOWED.

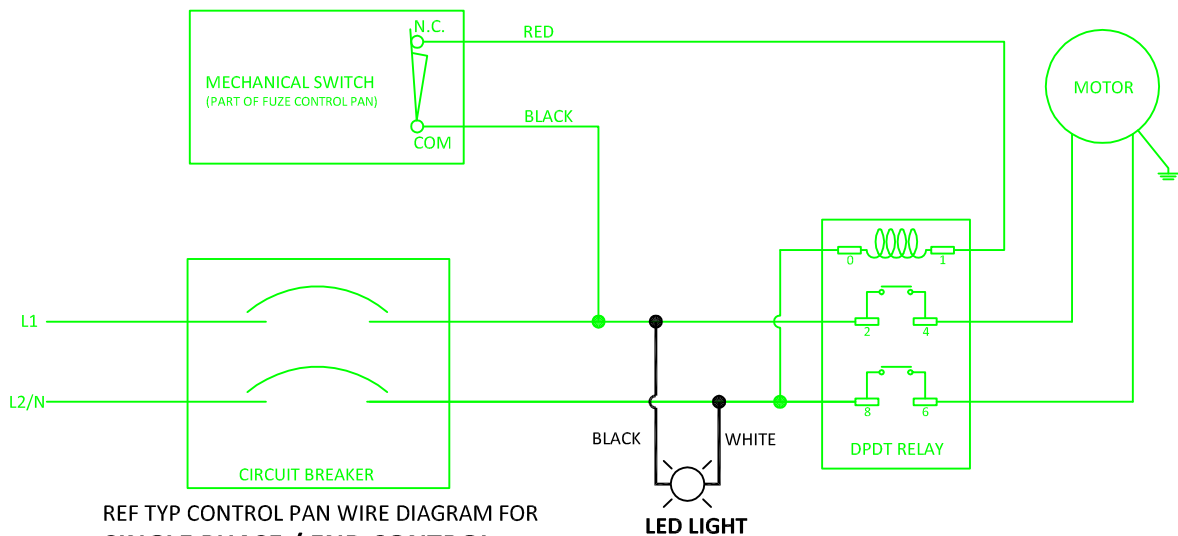

REF TYP CONTROL PAN WIRE DIAGRAM FOR  
**SINGLE PHASE / END CONTROL**  
WIRING MUST BE DONE BY LICENSED ELECTRICIAN.  
ALL LOCAL AREA CODES MUST BE FOLLOWED.

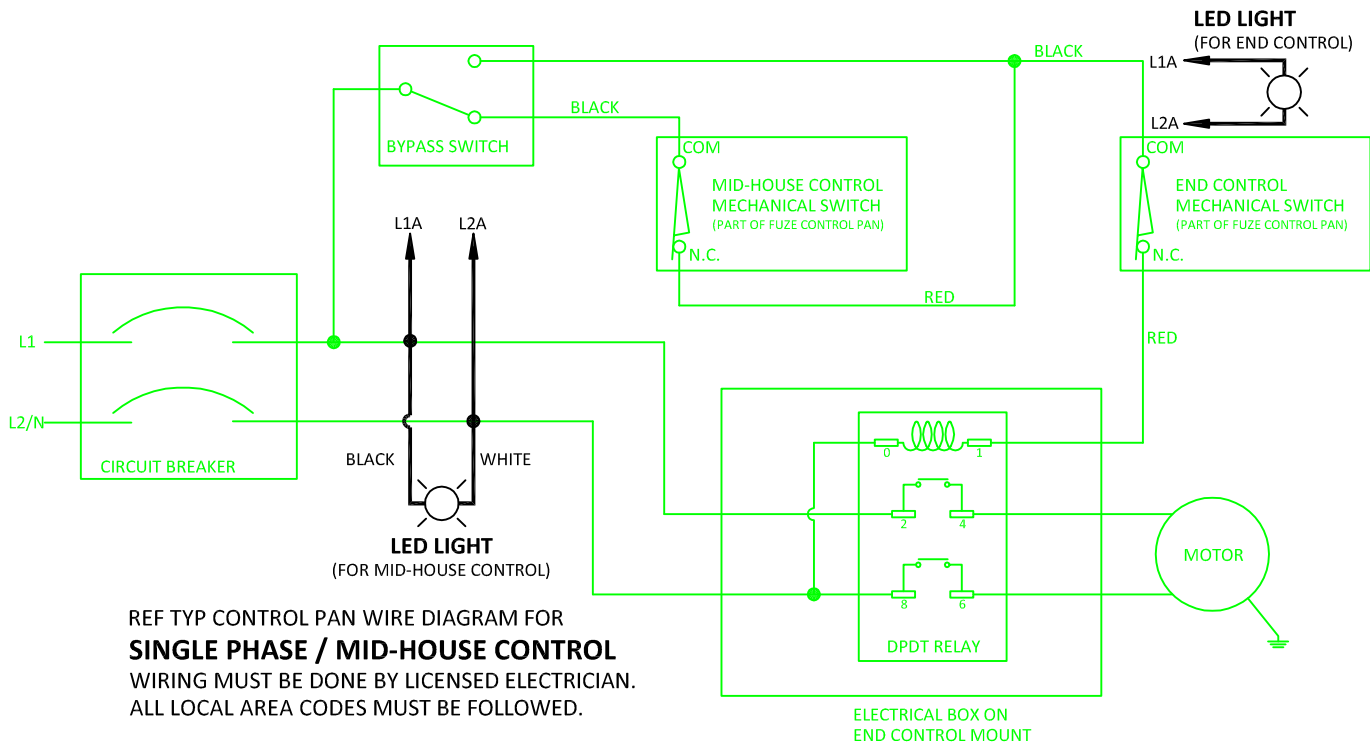

REF TYP CONTROL PAN WIRE DIAGRAM FOR  
**SINGLE PHASE / MID-HOUSE CONTROL**  
WIRING MUST BE DONE BY LICENSED ELECTRICIAN.  
ALL LOCAL AREA CODES MUST BE FOLLOWED.

Wiring Diagrams - 3 Phase

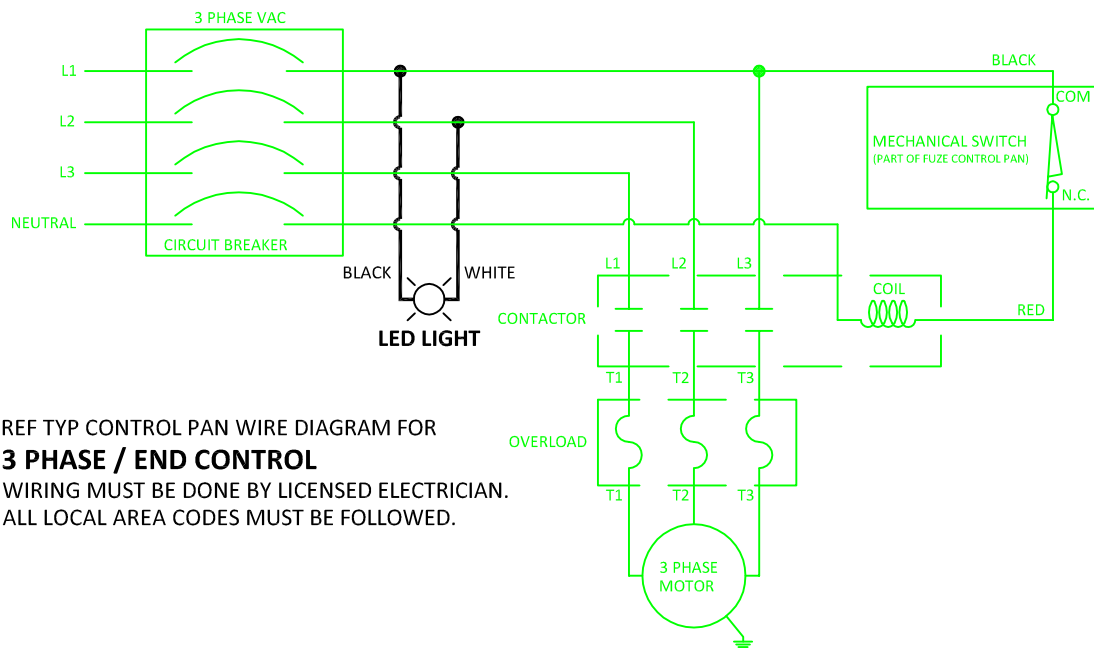

REF TYP CONTROL PAN WIRE DIAGRAM FOR  
**3 PHASE / END CONTROL**  
WIRING MUST BE DONE BY LICENSED ELECTRICIAN.  
ALL LOCAL AREA CODES MUST BE FOLLOWED.

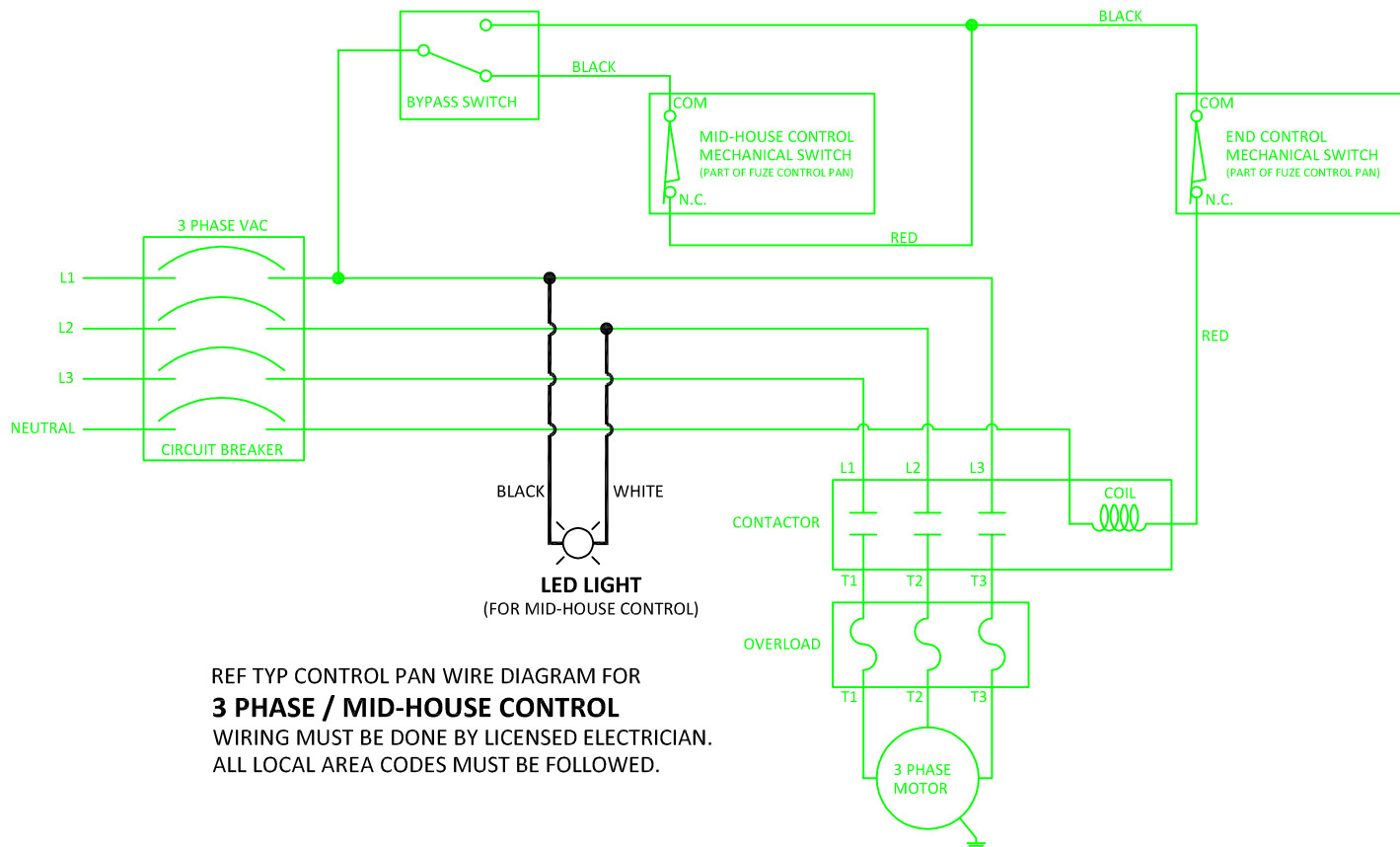

REF TYP CONTROL PAN WIRE DIAGRAM FOR  
**3 PHASE / MID-HOUSE CONTROL**  
WIRING MUST BE DONE BY LICENSED ELECTRICIAN.  
ALL LOCAL AREA CODES MUST BE FOLLOWED.

## LED Feeder Light Assembly - Exploded Drawing and Parts List

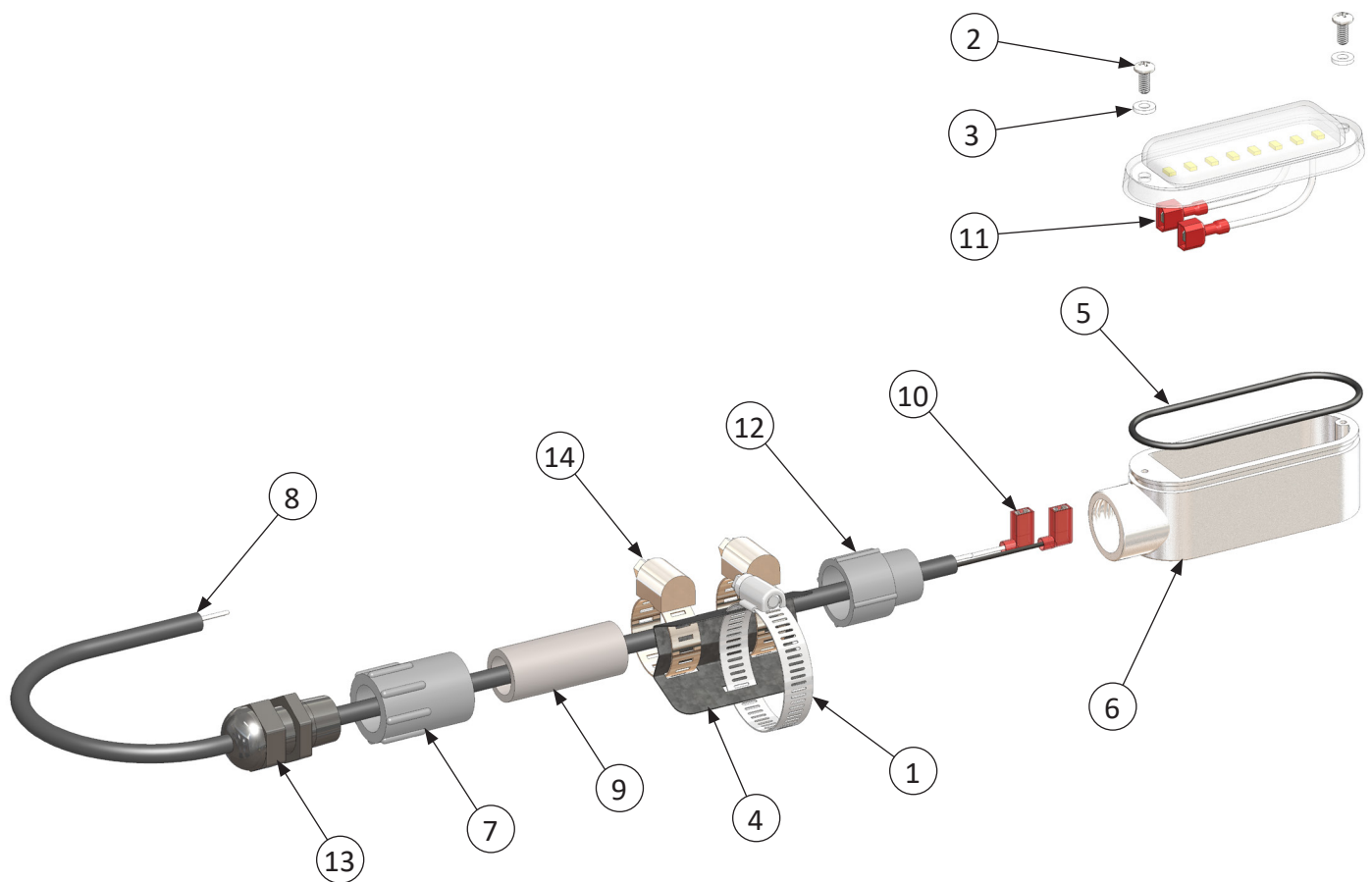

KEY	PART #	DESCRIPTION	QTY
<b>820022 - LED FEEDER LIGHT ASSEMBLY</b>			
1	451008	1-3/4" SS TUBE CLAMP	1
2	690319	8-32 X 3/8" PAN HEAD SCREW	2
3	690320	#8 FLAT NYLON WASHER	2
4	820184	BRACKET, LED FEEDER LIGHT	1
5	820208	O-RING, .103-.148, BUNA, 70A DUR	1
6	820555	LED LIGHT, 200LU, 230V, 50/60HZ	1
7	920808	1/2" NPFT X SKT ADAPTER, SCHEDULE 40	1
8	920946	CABLE, 18/2 AWG, 10A, 300V, .29 OD	3
9	921155	1/2" X 2" CONDUIT, SCHEDULE 40	1
10	980057	ELECTRICAL CONNECTOR, FLAG, FEM, .187 X .020, 22-18, FULLY INSULATED	2
11	980064	ELECTRICAL CONNECTOR, STRAIGHT, TAB, .187 X .020, 22-18, FULLY INSULATED	2
12	CN-004-001	1/2"NPTM X SKT ADAPTER, SCHEDULE 40	1
13	HW-71-011	1/2" STRAIN RELIEF CABLE DOME	1
14	PMHC3/4	3/4" TRIDON HOSE CLAMP	2

### North America:

Phone: 800.99VALCO (800.998.2526)

Fax: 419.678.2200

Email: [sales@val-co.com](mailto:sales@val-co.com)

990048

REV [C]

4

### International:

Phone: (+1) 419.678.8731

Fax: (+1) 419.678.2200

Email: [intl.sales@val-co.com](mailto:intl.sales@val-co.com)