



# Quick Sheet Instructions

775130: TUBE COUPLER, 2.375" OD, GALVANIZED  
775026: TUBE COUPLER, 2.375" OD, GALVANIZED, CARTON OF 15  
775201: TUBE COUPLER, 2.375" OD, STAINLESS STEEL  
775202: TUBE COUPLER, 2.375" OD, STAINLESS STEEL, CARTON OF 15

## IMPORTANT INSTALLATION NOTES:

Failure to follow these notes will void warranty.

All corners and tubes must be installed with proper alignment and suspension support. Tubes and corners must be straight and level. Tubes must be 90 degrees at corners. Improper alignment and support will cause premature wear of corners and tubes and excessive load on motor.

## Installation:

1. Support metal tubes every 8 ft.
2. Cut all tube ends square and remove burrs.
3. Rotate tubes so that weld flash is on top.
4. Rotate coupler so the tube intersection can be seen through flange.
5. Slide tubes into coupler, being sure to butt tubes together in middle of coupler.
6. Tighten fasteners until flanges are parallel, as shown.

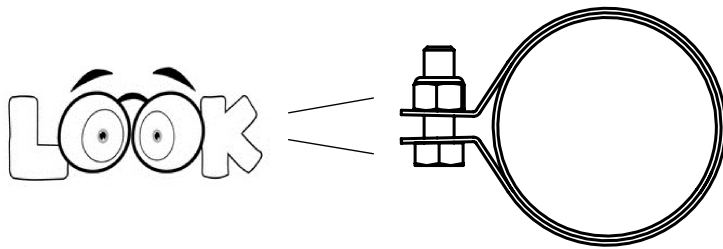

Be sure to visually confirm tubes meet in middle of coupler, so that equal support is given to each tube.

## NOTE:

Do not use impact or overtighten fasteners.

Joint is not designed to be dust free or weather tight.

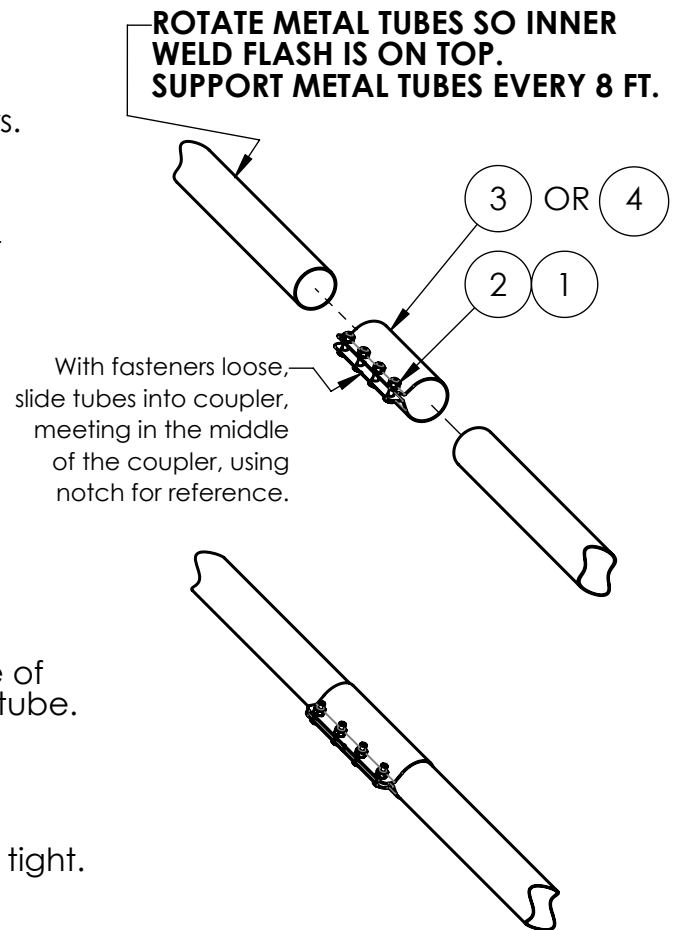

## BILL OF MATERIALS, PER ONE COUPLER

ITEM #	PART #	QTY.	DESCRIPTION	Description 2
1	010431	4	BOLT, HEX, 5/16-18 X 1"	SS, 18-8
2	MH90044	4	NUT, HEX, NYLOCK, 5/16-18	SS, 18-8
3	775131	1	TUBE COUPLER, 2.375" OD, GALV	-
4	775201	1	TUBE COUPLER, 2.375" OD, SS	-

## North America:

Phone: 800.99VALCO (800.998.2526)

Fax: 419.678.2200

Email: sales@val-co.com

990338 [B] 4/5/2024

Page 1

## International:

Phone: (+1) 419.678.8731

Fax: (+1) 419.678.2200

Email: intl.sales@val-co.com